



Performance



Accessibility



Best Practices



SEO

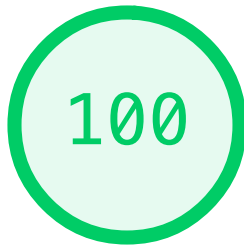

Performance

Values are estimated and may vary. The [performance score is calculated](#) directly from these metrics. [See calculator.](#)

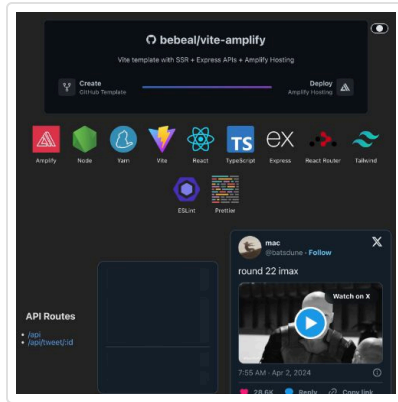

▲ 0-49 50-89 90-100

METRICS

[Expand view](#)

First Contentful Paint

0.4 s

Largest Contentful Paint

0.5 s

Total Blocking Time

0 ms

Cumulative Layout Shift

0.033

Speed Index

0.4 s

 [View Treemap](#)

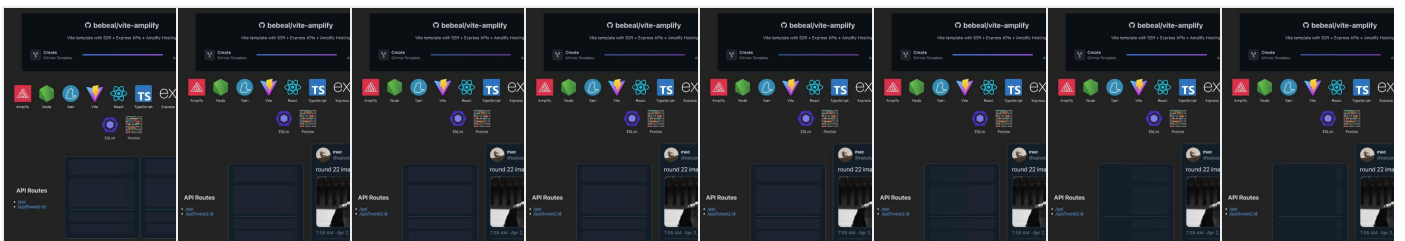

DIAGNOSTICS

- ▲ Reduce unused JavaScript — Potential savings of 26 KiB ▼
- Preload Largest Contentful Paint image ▼
- Avoid large layout shifts — 2 layout shifts found ▼
- Avoid non-composited animations — 8 animated elements found ▼
- Initial server response time was short — Root document took 60 ms ▼
- Avoids enormous network payloads — Total size was 141 KiB ▼
- Avoids an excessive DOM size — 260 elements ▼
- Avoid chaining critical requests — 2 chains found ▼
- JavaScript execution time — 0.0 s ▼
- Minimizes main-thread work — 0.2 s ▼
- Minimize third-party usage — Third-party code blocked the main thread for 0 ms ▼
- Largest Contentful Paint element — 520 ms ▼

More information about the performance of your application. These numbers don't [directly affect](#) the Performance score.

PASSED AUDITS (26)

Show

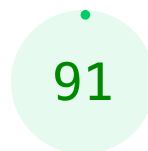

Accessibility

These checks highlight opportunities to [improve the accessibility of your web app](#). Automatic detection can only detect a subset of issues and does not guarantee the accessibility of your web app, so [manual testing](#) is also encouraged.

NAMES AND LABELS

- ▲ Links do not have a discernible name



These are opportunities to improve the semantics of the controls in your application. This may enhance the experience for users of assistive technology, like a screen reader.

BEST PRACTICES

- ▲ Touch targets do not have sufficient size or spacing.



These items highlight common accessibility best practices.

NAVIGATION

- The page contains a heading, skip link, or landmark region



These are opportunities to improve keyboard navigation in your application.

AUDIO AND VIDEO

- `<video>` elements contain a `<track>` element with `[kind="captions"]`



These are opportunities to provide alternative content for audio and video. This may improve the experience for users with hearing or vision impairments.

ADDITIONAL ITEMS TO MANUALLY CHECK (10)

[Show](#)

These items address areas which an automated testing tool cannot cover. Learn more in our guide on [conducting an accessibility review](#).

PASSED AUDITS (19)

[Show](#)

NOT APPLICABLE (34)

[Show](#)

96

Best Practices

USER EXPERIENCE

▲ Serves images with low resolution



TRUST AND SAFETY

○ Ensure CSP is effective against XSS attacks



PASSED AUDITS (13)

Show

NOT APPLICABLE (3)

Show



100

SEO

These checks ensure that your page is following basic search engine optimization advice. There are many additional factors Lighthouse does not score here that may affect your search ranking, including performance on [Core Web Vitals](#). [Learn more about Google Search Essentials](#).

ADDITIONAL ITEMS TO MANUALLY CHECK (1)

Show

Run these additional validators on your site to check additional SEO best practices.

PASSED AUDITS (9)

Show

NOT APPLICABLE (1)

Show

■ Captured at Jul 28, 2024, 9:58 PM PDT

■ Initial page load

■ Emulated Desktop with Lighthouse 12.0.0

■ Custom throttling

■ Single page session

■ Using Chromium 127.0.0.0 with devtools

Generated by **Lighthouse** 12.0.0 | [File an issue](#)